

## LOW- AND MAINS VOLTAGE LAMP HOLDERS



### LAMP HOLDERS FOR HALOGEN INCANDESCENT LAMPS

As the tungsten-halogen cycle and the high lamp current can cause very high temperatures when operating low-voltage halogen lamps, close attention must be paid to the luminaire's thermal conditions and components must be made of high-grade materials.

#### **VS lampholders for low-voltage halogen lamps**

The following chapter contains Vossloh-Schwabe's comprehensive range of connection elements, lampholders and accessories for safe and reliable installation in accordance with the latest regulations and developments.

#### **VS lampholders for mains voltage halogen lamps**

The following chapter contains Vossloh-Schwabe's comprehensive range of lampholders for single-ended halogen lamps (GU/GZ10 and G9 bases), lampholders for bayonet lamps (B15d and B22d bases) as well as lampholders for double-ended tubular lamps (R7s base).



## Lampholders for low-voltage halogen incandescent lamps

G4, GZ4, G5.3, GX5.3, G6.35, GY6.35 lampholders, accessories  
 G4 lampholders, GZ4 lamp connectors  
 Lampholders with separate mounting spring for GU4 lamps  
 GX5.3 lamp connectors  
 GU5.3 lampholders  
 Lampholders with separate mounting spring for GU5.3 lamps  
 G6.35, GY6.35 lampholders, GZ6.35 lamp connectors  
 G53 lamp connectors

## 260-267

260-261  
 261-263  
 264  
 265  
 265  
 266  
 267  
 267

## Lampholders for mains voltage halogen incandescent lamps

B15d, BA15d lampholders  
 G9 lampholders, accessories  
 GU10, GZ10 lampholders, accessories  
 R7s ceramic lampholders  
 R7s metal lampholders  
 Connection boxes  
 Connectors

## 268-277

268  
 268-270  
 271-272  
 273-275  
 275  
 276  
 277

## Technical details for incandescent lamps

General technical details  
 Glossary

## 314-327

348-356  
 357-359

1

2

3

4

5

6

7

8

9

10

## G4, GZ4, G5.3, GX5.3, G6.35, GY6.35 Lampholders, Accessories

### For low-voltage halogen incandescent lamps

The lampholders listed in this chapter permit the use of lamps with different bases. It is important to ensure that under no circumstances a lamp

with a smaller pin diameter is used if a lamp with a larger pin diameter has already been used.

G/GZ4, G/GX5.3, G/GY6.35 lampholder  
 Casing: LCP, natural, T270  
 Nominal rating: 8/24 (for G4/GZ4 lamps: 4/24)  
 Multipoint contacts: CuNiZn  
 Push-in terminals for stranded conductors with ferrule on bare end of core  $\varnothing$  1.4–1.8 mm  
 Fixing holes for screws M3  
 Weight: 2.4 g, unit: 1000 pcs.  
 Type: 33300  
**Ref. No.: 109547**

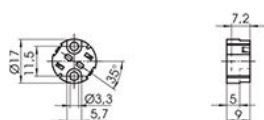

Cover caps  
 For push-fit onto lampholders type 333  
 External thread 20.8x2  
 Material: LCP, natural  
 Moulded thread: M10x1  
 Weight: 3.8 g, unit: 1000 pcs.  
 Type: 97255  
**Ref. No.: 109548**



Screw rings  
 For components with external thread 20.8x2  
 Weight: 1.7/1.4 g, unit: 1000 pcs.  
 Type: 97257  
**Ref. No.: 109550** PPS, black  
**Ref. No.: 507490** LCP, natural



G/GZ4, G/GX5.3, G/GY6.35 lampholder  
 Casing: LCP, natural, T270  
 Nominal rating: 8/24 (for G4/GZ4 lamps: 4/24)  
 Multipoint contacts: CuNiZn  
 Push-in terminals for stranded conductors with ferrule on bare end of core  $\varnothing$  1.4–1.8 mm  
 Fixing holes for screws M3  
 Weight: 2.6 g, unit: 1000 pcs.  
 Type: 33400  
**Ref. No.: 109674**

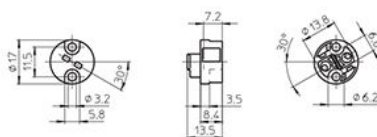

# Lampholders for Halogen Incandescent Lamps

G/GZ4, G/GX5.3, G/GY6.35 lampholder

Casing: ceramic, cover plate: mica  
T350

Nominal rating: 10/24

Contacts: Ni

Leads: Cu nickel-plated, stranded conductors  
0.75 mm<sup>2</sup>, PTFE-insulation, length: 140 mm

Fixing holes for screws M3

Weight: 6.8 g, unit: 500 pcs.

Type: 32400

**Ref. No.: 100939**

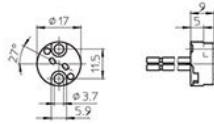

1

G/GZ4, G/GX5.3, G/GY6.35 lampholder

Casing: ceramic, cover plate: mica  
T300

Nominal rating: 10/24

Multipoint contacts: CuNiZn

Leads: Cu nickel-plated, stranded conductors  
0.75 mm<sup>2</sup>, PTFE-insulation, length: 140 mm

Fixing holes for screws M3

Weight: 7.1 g, unit: 1000 pcs.

Type: 32700

**Ref. No.: 101258**

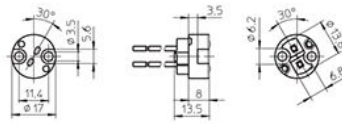

3

G/GZ4, G/GX5.3, G/GY6.35 lampholder

Casing: ceramic, cover plate: mica  
T300, nominal rating: 10/24

Multipoint contacts: CuNiZn

Leads: Cu nickel-plated, stranded conductors  
0.75 mm<sup>2</sup>, PTFE-insulation, length: 140 mm

Fixing plate: zinc-coated polished steel

Fixing holes for screws M3

Weight: 8.8 g, unit: 1000 pcs.

Type: 32720

**Ref. No.: 101274**

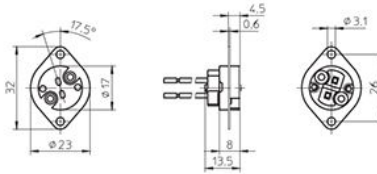

5

## G4 Lampholders, GZ4 Lamp Connectors

**For low-voltage halogen incandescent lamps**

G4 lampholder, GZ4 lamp connector

Casing: PPS, black, T240

Nominal rating: 4/24, multipoint contacts: steel

Leads: Cu tinned, stranded conductors 0.75 mm<sup>2</sup>,  
Si-insulation, length: 140 mm

Option for lateral wiring

Lampholder height: 16 mm

Fixing holes for screws M3

Weight: 5.7 g, unit: 1000 pcs.

Type: 30400

**Ref. No.: 530024**

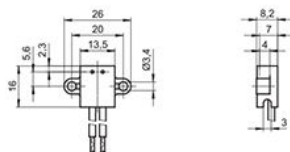

9

10

# Lampholders for Halogen Incandescent Lamps

G4 lampholder, GZ4 lamp connector  
 Casing: PPS, black, T240  
 Nominal rating: 4/24, multipoint contacts: steel  
 Leads: Cu tinned, stranded conductors 0.75 mm<sup>2</sup>,  
 Si-insulation, length: 140 mm  
 Lampholder height: 12.8 mm  
 Fixing holes for screws M3  
 Weight: 5.5 g, unit: 1000 pcs.  
 Type: 30450  
**Ref. No.: 530025**

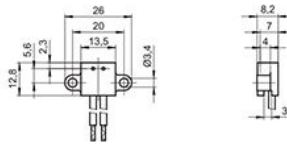

G4 lampholder, GZ4 lamp connector  
 Casing: PPS, black, T240  
 Nominal rating: 4/24, multipoint contacts: steel  
 Leads: Cu tinned, stranded conductors 0.75 mm<sup>2</sup>,  
 Si-insulation, length: 140 mm  
 Option for lateral wiring  
 Lampholder height: 16 mm  
 For push-fit onto the lamp  
 Weight: 5.3 g, unit: 1000 pcs.  
 Type: 30460  
**Ref. No.: 530026**

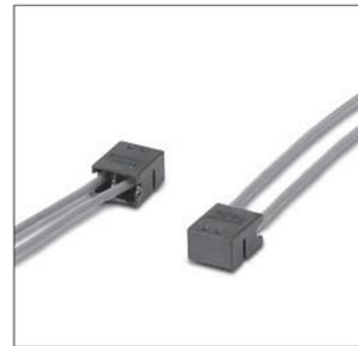
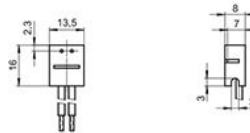

G4 lampholder, GZ4 lamp connector  
 Casing: PPS, black, T240  
 Nominal rating: 4/24, multipoint contacts: steel  
 Leads: Cu tinned, stranded conductors 0.75 mm<sup>2</sup>,  
 Si-insulation, length: 140 mm  
 Option for lateral and base wiring  
 Lampholder height: 12.8 mm  
 For push-fit onto the lamp  
 Weight: 5.1 g, unit: 1000 pcs.  
 Type: 30465  
**Ref. No.: 530027**

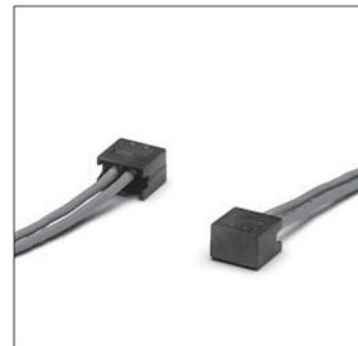
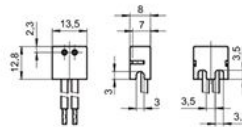

G4 lampholders  
 For push-fit into lampholder support 535267  
 T240  
 Nominal rating: 2/50  
 Multipoint contacts: CuNiZn  
 Push-in terminals for stranded conductors  
 with ferrule on bare end of core Ø 1.4–1.8 mm  
 Weight: 1.5/1.6 g, unit: 1000 pcs.  
 Type: 30800  
**Ref. No.: 535146** material: LCP  
**Ref. No.: 535263** material: PPS

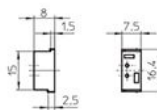

Lampholder support for G4 lampholders type 30800  
 Material: polyamide  
 Base split pins for wall thickness 0.6 mm  
 Weight: 0.8 g, unit: 500 pcs.  
 Type: 95300  
**Ref. No.: 535267**

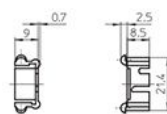

# Lampholders for Halogen Incandescent Lamps

## G4 lampholder

Casing: PPS, black, T200

Nominal rating: 2/24

Multipoint contacts: CuNiZn

Leads: Cu tinned, stranded conductors 0.75 mm<sup>2</sup>,

Si-insulation brown/blue, length: 140 mm

Push-in fixing

Weight: 4.4 g, unit: 1000 pcs.

Type: 30485

**Ref. No.: 535988**

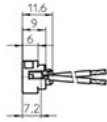

1

2

## G4 clip-in tube lampholder

With earth contact

Casing: PPS, black, T200

Nominal rating: 2/24

Multipoint contacts: CuNiZn

Lead: Cu tinned, stranded conductors 0.75 mm<sup>2</sup>,

Si-insulation blue, length: 140 mm

Push-in fixing

Weight: 2.7 g, unit: 1000 pcs.

Type: 30471

**Ref. No.: 108449**

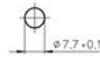
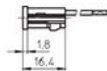

3

4

## G4 clip-in tube lampholder

With integrated cable holder for Teflon conductor

Casing: PPS, black, T200

Nominal rating: 2/24

Multipoint contacts: CuNiZn

Leads: Cu tinned, stranded conductors 0.61 mm<sup>2</sup>,

FEP-insulation brown/blue, length: 140 mm

Push-in fixing

Weight: 8.1 g, unit: 1000 pcs.

Type: 30470

**Ref. No.: 520865**

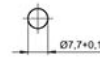
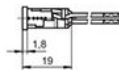

5

6

## G4 lampholder

Casing: PPS, black, T240

Nominal rating: 4/24

Multipoint contacts: steel

Leads: Cu tinned, stranded conductors 0.75 mm<sup>2</sup>,

Si-insulation, length: 140 mm

For push-fit onto the lamp

Weight: 4.7 g, unit: 1000 pcs.

Type: 34000

**Ref. No.: 507105**

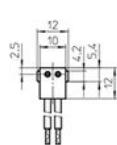

7

8

9

10

## Lampholders with Separate Mounting Spring for GU4 Lamps

For low-voltage halogen incandescent lamps

G/GZ4, G/GX5.3, G/GY6.35 lampholder  
 Casing: LCP, natural, T270  
 Nominal rating: 8/24 (for G4/GZ4 lamps: 4/24)  
 Multipoint contacts: CuNiZn  
 Push-in terminals for stranded conductors with ferrule on bare end of core  $\varnothing$  1.4–1.8 mm  
 Fixing holes for screws M3  
 For cover cap (see p. 268)  
 Weight: 2.4 g, unit: 1000 pcs.  
 Type: 33300

**Ref. No.: 109547**

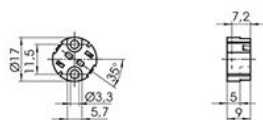

GU4 mounting spring for lamp  
 Material: stainless steel  
 For push-fit onto lampholders type 333 and 32210  
 Weight: 0.8 g, unit: 1000 pcs.  
 Type: 94095

**Ref. No.: 109553**

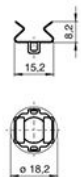

G/GZ4-, G/GX5.3, G/GY6.35 lampholder  
 Casing: ceramic, cover plate: mica  
 T350  
 Nominal rating: 10/24  
 Contacts: Ni  
 Leads: Cu nickel-plated, stranded conductors  
 0.75 mm<sup>2</sup>, PTFE-insulation, length: 140 mm  
 Fixing holes for screws M3  
 Weight: 6.8 g, unit: 500 pcs.  
 Type: 32400

**Ref. No.: 100939**

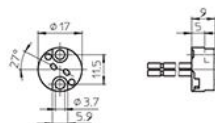

GU4 mounting spring for lamp  
 Material: stainless steel  
 The mounting spring has to be fastened to the lampholder 100939.  
 The luminaire manufacturer is responsible for the attachment.  
 Weight: 1.6 g, unit: 1000 pcs.  
 Type: 94071

**Ref. No.: 108678**



## GX5.3 Lamp Connectors

For low-voltage halogen incandescent lamps

GX5.3 lamp connectors

Casing: ceramic, cover plate: mica

T300, nominal rating: 10/24

Multipoint contacts: Ni

Leads: Cu nickel-plated, stranded conductors

0.75 mm<sup>2</sup>, PTFE-insulation, length: 140 mm

Weight: 7.8/8.5 g, unit: 500 pcs.

Type: 32600 holes for screws M3

**Ref. No.: 101162**

Type: 32620 threaded bushes M3

**Ref. No.: 101207**

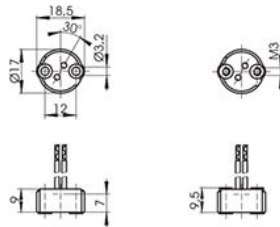

## GU5.3 Lampholders

For low-voltage halogen incandescent lamps

GU5.3 lampholder

Casing: ceramic, cover plate: mica

T350, nominal rating: 10/24

Contacts: Ni

Leads: Cu nickel-plated, stranded conductors

0.75 mm<sup>2</sup>, PTFE-insulation, length: 140 mm

Fixing holes for screws ST2.9

Mounting spring for lamp: stainless steel

Weight: 9.1 g, unit: 1000 pcs.

Type: 32480

**Ref. No.: 106457**

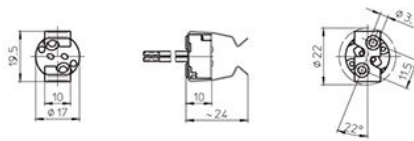

GU5.3 lampholders

Casing: ceramic, cover plate: mica

T300, nominal rating: 10/24, multipoint contacts: Ni

Leads: Cu nickel-plated, stranded conductors

0.75 mm<sup>2</sup>, PTFE-insulation, length: 140 mm

Mounting spring for lamp: stainless steel

Weight: 11/12 g, unit: 500 pcs.

Type: 32680 holes for screws M3

**Ref. No.: 101248**

Type: 32690 threaded bushes M3

**Ref. No.: 101253**

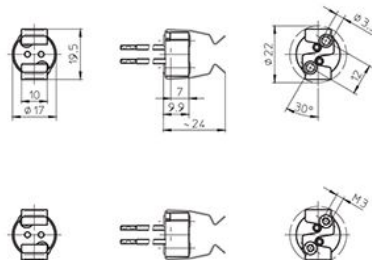

1

2

3

4

5

6

7

8

9

10



## Lampholders with Separate Mounting Spring for GU5.3 Lamps

For low-voltage halogen incandescent lamps

G/GZ4, G/GX5.3, G/GY6.35 lampholder  
 Casing: LCP, natural, T270  
 Nominal rating: 8/24 (for G4/GZ4 lamps: 4/24)  
 Multipoint contacts: CuNiZn  
 Push-in terminals for stranded conductors with ferrule on bare end of core  $\varnothing$  1.4–1.8 mm  
 Fixing holes for screws M3  
 For cover cap (see p. 260)  
 Weight: 2.4 g, unit: 1000 pcs.  
 Type: 33300

**Ref. No.: 109547**

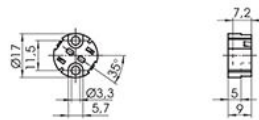

GU5.3 mounting spring for lamp  
 Material: stainless steel  
 For push-fit onto lampholders type 333  
 Weight: 1.1 g, unit: 1000 pcs.  
 Type: 94096

**Ref. No.: 109554**

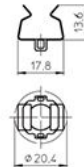

G/GZ4, G/GX5.3, G/GY6.35 lampholder  
 Casing: ceramic, cover plate: mica  
 T350  
 Nominal rating: 10/24  
 Contacts: Ni  
 Leads: Cu nickel-plated, stranded conductors 0.75 mm<sup>2</sup>, PTFE-insulation, length: 140 mm  
 Fixing holes for screws M3  
 Weight: 6.8 g, unit: 500 pcs.  
 Type: 32400

**Ref. No.: 100939**

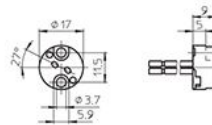

GU5.3 mounting spring for lamp  
 Material: stainless steel  
 The mounting spring has to be fastened to the lampholder 100939.  
 The luminaire manufacturer is responsible for the attachment.  
 Weight: 2 g, unit: 1000 pcs.  
 Type: 94060

**Ref. No.: 106256**

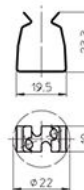

## G6.35, GY6.35 Lampholders, GZ6.35 Lamp Connectors

For low-voltage halogen incandescent lamps

G/GY6.35 lampholder, GZ6.35 lamp connector

Casing: ceramic, cover plate: mica

T300, nominal rating: 10/24

Multipoint contacts: Ni

Leads: Cu nickel-plated, stranded conductors

0.75 mm<sup>2</sup>, PTFE-insulation, length: 140 mm

Fixing holes for screws M3

Lamp fixing holes: diagonal

Weight: 11 g, unit: 500 pcs.

Type: 30300

**Ref. No.: 100662**

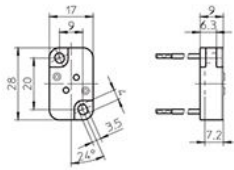

## G53 Lamp Connectors

For low-voltage halogen incandescent lamps

G53 lamp connector

Casing: PPS, black

Nominal rating: 10/24

Contacts: CuNiZn

Lead: Cu tinned, stranded conductors 0.75 mm<sup>2</sup>,

Si-insulation, length: 140 mm

Fixing hole for screw M4

Lead exit: lateral

Weight: 4.4 g, unit: 1000 pcs.

Type: 33100

**Ref. No.: 107694**

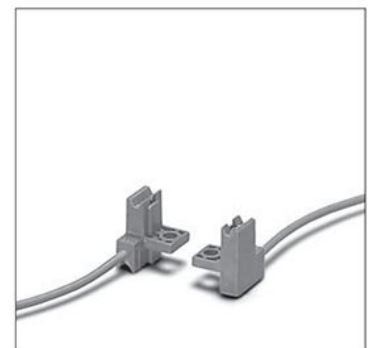
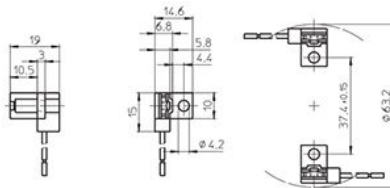

1

2

3

4

5

6

7

8

9

10